

2 REAR ELEVATION



4 LEFT ELEVATION

COLOR SCHEME KEY

- | | |
|---|---|
| 1 | MAIN
SW 7757
HIGH REFLECTIVE WHITE |
| 2 | TRIMS
SW 7646
FIRST STAR |
| 3 | DETAIL COLOR
SW 7648
BIG CHILL |
| 4 | AWNING/BRACKETS
SW 7104
COTTON WHITE |
| 5 | RAILING/WINDOWS/
DOOR FRAMES
SW 7048
URBANE BRONZE |
| 6 | SHUTTERS/GARAGE DOORS
SW 9177
SALTY DOG |
| 7 | ROOFS
BARREL TILES
HUES OF CHARCOAL |
| 8 | STONE VENEER
FRENCH LIMESTONE CREAM |

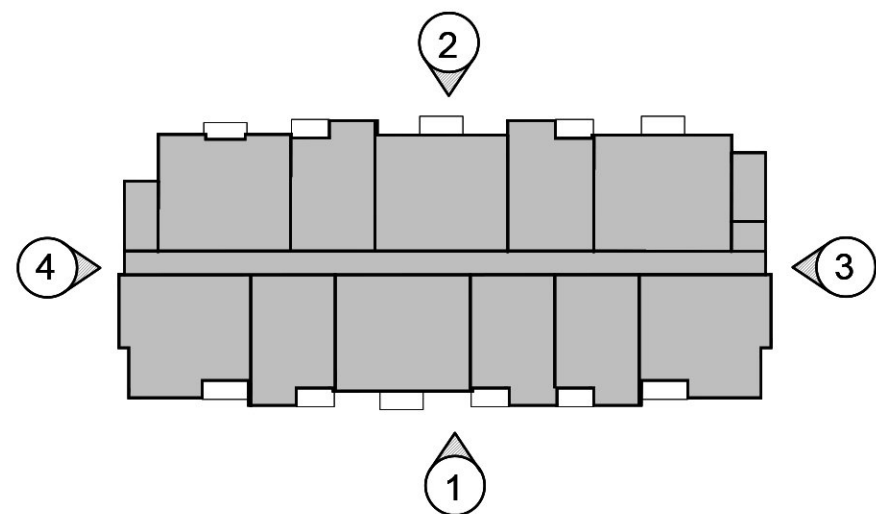

KEYPLAN

N.T.S.

BLDG IIB ELEVATIONS

SCALE: 1/8"=1'-0"

P&Z

P223-12000017

06-25-2025

ARCHITECT'S BUILDING CODE STATEMENT/ TO THE BEST OF THE ARCHITECT'S KNOWLEDGE THE PLANS AND SPECIFICATIONS COMPLY WITH THE FLORIDA BUILDING CODE SEVENTH EDITION (2020) AND THE APPLICABLE FIRE SAFETY STANDARDS AS DETERMINED BY THE LOCAL AUTHORITY AND CHAPTER 633, FLORIDA STATUTES.

PRE-APP. MEETING	04/04/2023	BY
DRC SUBMITTAL	06/13/2023	
DRC RE-SUBMITTAL	08/16/2023	
DRC RE-SUBMITTAL	01/01/2024	
DRC RE-SUBMITTAL	10/16/2024	
DRC RE-SUBMITTAL	12/10/2024	

OAKS @ PALM AIRE

FOR:
MORGUARD
LOCATED AT:
POMPANO BEACH, FLORIDA



JOSE I. SAUMELL
AR0013085

MSA ARCHITECTS, INC.
AAC000895

8950 SW 74th COURT
SUITE 1513
MIAMI, FLORIDA 33156
(305) 273-9911

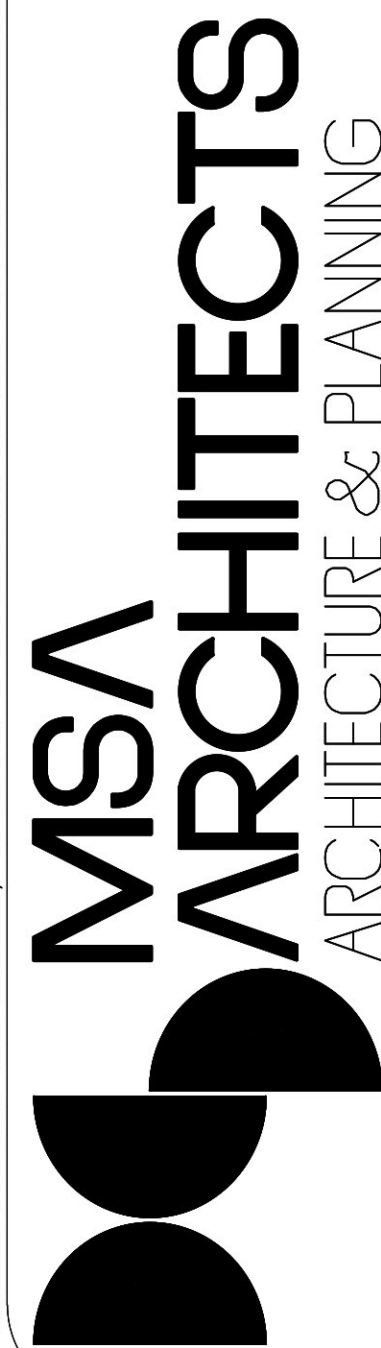

DRAWN
CONTRACT DATE 10/12/22
SCALE AS SHOWN
JOB NO. 2181.PRJ
SHEET TITLE:

BLDG ELEVATIONS

SHEET NUMBER:

A-3.2.2B